



BI6204PG1GF

5-Port Gigabit Industrial PoE+Fiber Switch

Datasheet

Key Features:

Ports: Provide 4*10/100/1000Mbps PoE ports with 1*1000Mbps Ethernet and 1.25Gbps SFP

PoE Standard: IEEE802.3af/at Power over Ethernet (PoE) Compliant

Self-adaption: RJ45 port supports 10/100/1000Mbps Auto MDI/MDIX

Industrial Installation: Din Rail mounting installation

Wide Application: Designed for Railway, traffic etc some Industrial environment

Surge protection: Protect the device from lightning surges and others electrical hazards

Working Temperature: -40 to 85 degrees operating temperature

Considerate Design: IP40 Industrial enclosure

Easy to use: Plug and play, No configuration required

Environmentally Hardened Design

With the **IP40** metal industrial case which provides a high level of immunity against electromagnetic interference and heavy electrical surges, Being able to operate under the temperature range from **-40 to 85 degrees C**, the BI6204PG1GF can be placed in almost any difficult environment.

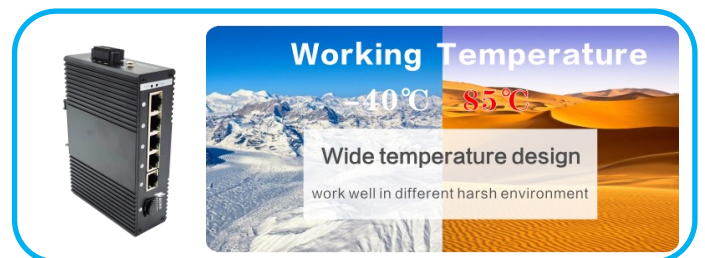

Dual Power input for High Availability Network

Featuring a strong dual power input system with wide-ranging voltages (36V~56V DC) incorporated into customer's automation network to enhance system reliability and uptime which make the installation more flexible and convenient.

Surge Protection Design

provides contact discharge of $\pm 8\text{KV}$ DC and air discharge of $\pm 15\text{KV}$ DC for Ethernet ESD protection. It also supports $\pm 6\text{KV}$ surge immunity to improve product stability and protects users' networks from devastating ESD attacks, making sure the flow of operation does not fluctuate.

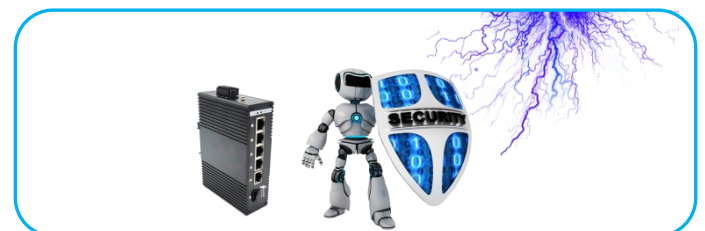

Technical Datasheet

Model	BI6204PG1GF	
Hardware Specifications		
ports	5*10/100/1000BASE-T RJ45 auto-MDI/MDI-X ports 1*1.25Gbps SFP Slot	
Connector	Removable 4-pin terminal block Pin 1/2 for Power 1; Pin 3/4 for Power 2	
LED Display	Power Indicator: PWR(green).Network Indicator: Link(yellow) SFP: Green	
Power requirements	36~56V DC	
Installation	DIN-rail kit and wall-mount kit	
Switch Performance	Backplane bandwidth	20Gbps
	Packet forwarding rate	8.93Mpps
	MAC address	4k
	Flow control	Back pressure for half duple. IEEE 802.3x pause frame for full duplex
Enclosure	IP40 Metal case	
ESD Protection	6KV ESD	
Dimension(W x D x H)	38mm*95mm *135mm(1.5in x 3.74in x 4.65in)	
Weight	0.65Kg	
Power over Ethernet (PoE) Specifications		
Network standard	IEEE802.3i 10 BASE-T	
	IEEE802.3u 100 BASE-TX	
	IEEE802.3ab 1000BASE-T	
	IEEE802.3x Flow Control	
	IEEE802.3af Power over Ethernet	
	IEEE802.3at Power over Ethernet	
PoE Standard	IEEE802.3af Power over Ethernet/PSE	
	IEEE 802.3at Power over Ethernet Plus/PSE	
PoE Supply Type	1/2(+), 3/6(-) End-span	
PoE Power Output	Per Port 52V DC, 300mA. max. 15.4 watts (IEEE 802.3af)	
	Per Port 52V DC, 600mA. max. 30 watts (IEEE 802.3at)	
PoE Power budget	65/120W Optional	
Environment		
Environment specification	Operating temperature: -40℃~85℃, operating humidity: 5%~95%	
	Storage temperature: -40℃~85℃, storage humidity: 5%~95%	
Warranty	5 Years	

Installation Models

Power Terminal

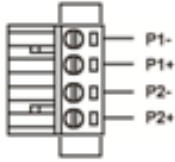

- ◆ 4-pin 3.81mm-spacing plug-in terminal
- ◆ 12V-54VDC wide voltage input
- ◆ P1&P2 dual power input
- ◆ Reverse protection

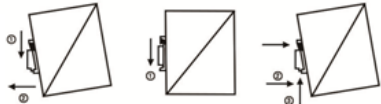

Din-Rail

Earth Protection

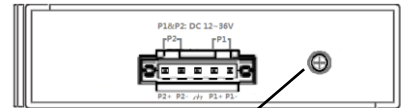

Ground terminal or screw

Mechanical Drawing

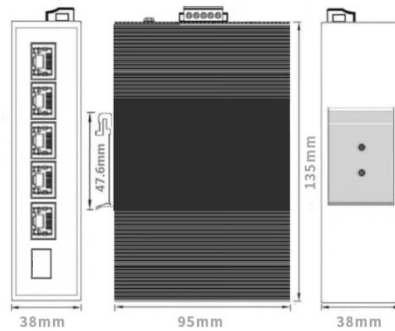

Applications

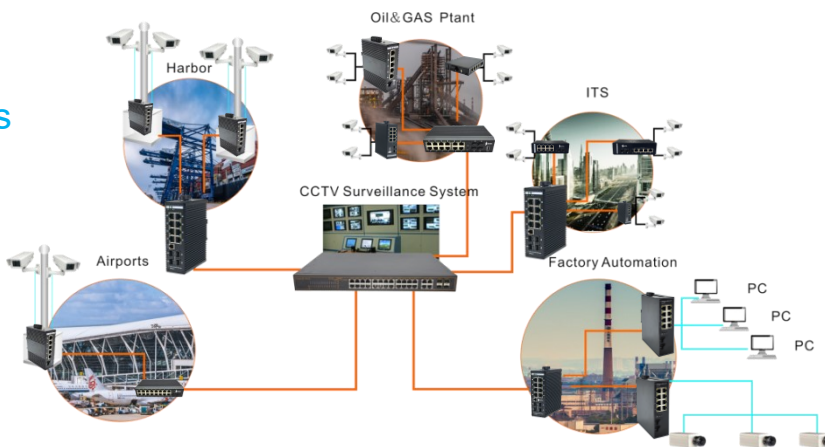

Ordering Information

BI6204PG1GF

4 Ports 10/100/1000Mbps Industrial PoE Switch With 1 Ethernet and 1 SFP uplink, Adaptor excluded, Din rail

337 Forest Road
London, United Kingdom

+44 7859 571344



Info@bornelectronics.com



https://bornelectronics.com