

BT621TE1T

Industrial 10G/2.5G/1G/100M Copper to 10GBASE-X SFP+ Media Converter

Datasheet



Key Features:

Ports: Provide 1*100/1G/2.5G/10G BASE-T RJ45 interface with auto MDI/MDI-X function, 10GBASE-X SFP+ slot interface

Standard: IEEE 802.3u/802.3ab/802.3bz/802.3ae Ethernet standard compliant

Self-adaption: Supports auto-negotiation 100Mbps, 1Gbps half/full duplex and 2.5/10Gbps full duplex mode

Industrial Installation: Din Rail mounting installation

Wide Application: Designed for Railway, traffic etc some Industrial environment

Surge protection: Protect the device from lightning surges and others electrical hazards

Working Temperature: -40 to 85 degrees operating temperature

Considerate Design: IP40 Industrial design with dual power input

Industrial-grade 10G Ethernet Media Converter

BT621TE1T is compact Industrial-grade 10G Ethernet Media Converter providing non-blocking wire-speed performance and great flexibility for 10 Gigabit Ethernet extension in harsh industrial environment. It is equipped with one 100Mbps, 1Gbps, 2.5Gbps and 10GBASE-T RJ45 copper interface and one 10GBASE-X SFP+ fiber optic interface delivered in an IP40 rugged but compact-sized case with redundant power system. The BT621TE1T is ideal for wide applications from copper to fiber media conversion wherever 10Gigabit bandwidth is required in climatically demanding environments with wide temperature ranging from -40 to 80 degrees C.

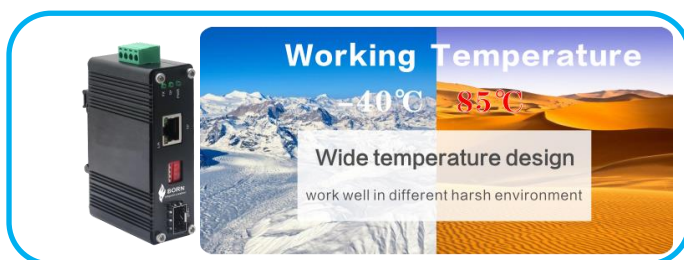

Environmentally Hardened Design

With the **IP40** metal industrial case which provides a high level of immunity against electromagnetic interference and heavy electrical surges, Being able to operate under the temperature range from **-40 to 85 degrees C**, the BT621TE1T can be placed in almost any difficult environment.

Surge Protection Design

provides contact discharge of $\pm 8\text{KV}$ DC and air discharge of $\pm 15\text{KV}$ DC for Ethernet ESD protection. It also supports $\pm 6\text{KV}$ surge immunity to improve product stability and protects users' networks from devastating ESD attacks, making sure the flow of operation does not fluctuate.



Technical Datasheet

Model	BT621TE1T	
Hardware Specifications		
Connector	1* 10G/2.5G/1G/100M BASE-T RJ45 auto MDI/MDIX ports	
Optical Port	1* 10G Base-X SFP+ Slots (LC connector)	
LED Display	Power Indicator: PWR(green).Network Indicator: L/A(yellow) FX: SFP+ Fiber Port Status TP: Ethernet Status	
Thermal Fan	Fanless Design	
Installation	Din Rail	
Switch Architecture	Store and Forward	
Transmission model	IEEE802.3X full-duplex and Backpressure half-duplex	
Switch Performance	Backplane bandwidth	20Gbps
	Packet forwarding rate	21Mpps
	MAC address	8k
Power requirement	DC 12V~48V	
ESD Protection	6KV ESD	
Dimension(WxDxH)	30mm x70mm x 95mm(1.18in x 2.76in x7.74in)	
Weight	<0.25kg	
Network standard	IEEE802.3i 10 BASE-T	
	IEEE802.3u 100 BASE-TX	
	IEEE802.3ab 1000BASE-T	
	IEEE 802.3bz 2.5GBASE-T	
	IEEE 802.3an 10GBASE-T	
	IEEE 802.3ae 10Gbps Ethernet	
	IEEE802.3x Flow Control	
IEEE802.3az EEE		
Forward & Filtering Rate:	100Mbps; 1000Mbps; 2.5Gbps; 10Gbps	
Network Cables:	10G/2.5G/1G/100M BASE-T:	
	10G - Cat 6A/7	
	1G/2.5G - Cat 5e/6/6A/7	
	100M - Cat 5/5e/6/6A/7	
	Cat 5/5e/6/6A/7 UTP cable (100 meters, max.) EIA/TIA-568 100-ohm STP (100 meters, max.)	
	10GBASE-LR/SR/BX:	
	50/125 μ m or 62.5/125 μ m multi-mode fiber optic cable, up to 300m 9/125 μ m single-mode fiber optic cable, up to 80km	
Environment		
Safety	FCC Part15 Class A,CE,RoHs	
Environment specification	Operating temperature: -40°C~85°C , operating humidity: 5%~95%	
	Storage temperature: -40°C~85°C , storage humidity: 5%~95%	

DIP Switch

4-digit DIP switch function

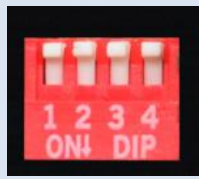

DIP

Function

Settings

SW 1

Reserved

ON - Reserved

OFF - Reserved

SW 2

Reserved

ON - Reserved

OFF - Reserved

SW 3

Reserved

ON - Reserved

OFF - Reserved

SW 4

Reserved

ON - Reserved

OFF - Reserved

Note: DIP Switch's function can be customized based on client's requirements.

Installation Models

Power Terminal

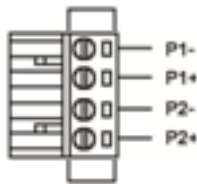

- ◆ 4-pin 3.81mm-spacing plug-in terminal
- ◆ 12V-48VDC wide voltage input
- ◆ P1&P2 dual power input
- ◆ Reverse protection

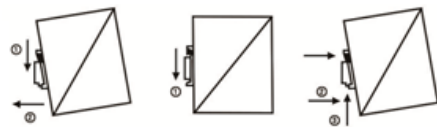

Din-Rail

Earth Protection

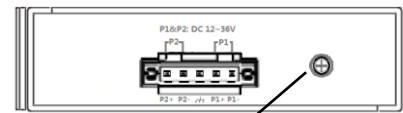

Ground terminal or screw

Applications

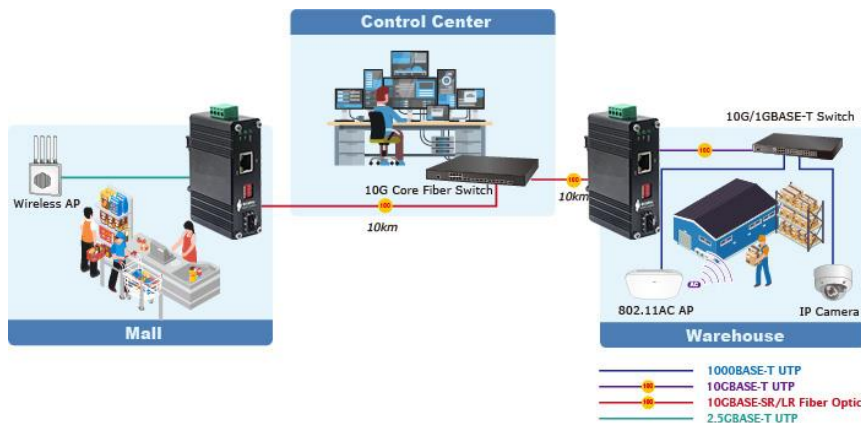

Ordering Information

BT621TE1T

Industrial 10G//2.5G/1G/100M Copper to 10GBASE-X SFP+ Media Converter.SFP module excluded,Din rail,



337 Forest Road
London, United Kingdom



Info@bornelectronics.com



+44 7859 571344



https://bornelectronics.com