

# BI6202G2F

## 4-Port Gigabit Industrial Switch

### Datasheet



#### Key Features:

- Ports:** Provide 2\*10/100/1000Mbps ports with 2\* 1.25Gbps SFP
- Self-adaption:** RJ45 port supports 10/100/1000Mbps Auto MDI/MDIX
- Industrial Installation:** Din Rail mounting installation
- Wide Application:** Designed for Railway, traffic etc some Industrial environment
- Surge protection:** Protect the device from lighting surges and others electrical hazards
- Working Temperature:** -40 to 85 degrees operating temperature
- Considerate Design:** IP40 Industrial enclosure
- Easy to use:** Plug and play, No configuration required

#### Environmentally Hardened Design

With the **IP40** metal industrial case which provides a high level of immunity against electromagnetic interference and heavy electrical surges, Being able to operate under the temperature range from **-40 to 85 degrees C**, the BI6202G2F can be placed in almost any difficult environment.



#### Surge Protection Design

provides contact discharge of  $\pm 8\text{KV}$  DC and air discharge of  $\pm 15\text{KV}$  DC for Ethernet ESD protection. It also supports  $\pm 6\text{KV}$  surge immunity to improve product stability and protects users' networks from devastating ESD attacks, making sure the flow of operation does not fluctuate.



#### Dual Power input for High Availability Network

Featuring a strong dual power input system with wide-ranging voltages (12V~54V DC) incorporated into customer's automation network to enhance system reliability and uptime which make the installation more flexible and convenient.



#### Gigabit SFP Uplink Port

With two SFP module slot available, the SFP uplink port is ideal for connecting the switch to the network's backbone, providing more than enough bandwidth and stability for ultra high speed data transferring, Beside the SFP can transmitte the date with Max 100Km distance with more economic solution.

# BI6202G2F

## 2-Port 10/100/1000Mbps Industrial Switch with 2 Gigabit SFP

### Technical Datasheet

<b>Model</b>	<b>BI6202G2F</b>	
<b>Hardware Specifications</b>		
ports	2* 10/100/1000BASE-T RJ45 auto-MDI/MDI-X ports 2* 1.25Gbps SFP Slot	
Connector	Removable 4-pin terminal block Pin 1/2 for Power 1; Pin 3/4 for Power 2	
LED Display	Power Indicator: PWR(green).Network Indicator: Link(yellow) SFP: Green	
Power requirements	12~54V DC	
Power Consumption	Less than 3 Watts	
Switch Performance	Backplane bandwidth	20Gbps
	Packet forwarding rate	5.96Mpps
	MAC address	8k
	Flow control	Back pressure for half duple. IEEE 802.3x pause frame for full duplex
Network standard	IEEE802.3i 10 BASE-T	
	IEEE802.3u 100 BASE-TX	
	IEEE802.3ab 1000BASE-T	
	IEEE802.3x Flow Control	
IEEE802.3az EEE		
Enclosure	IP40 Metal case	
ESD Protection	6KV ESD	
Dimension(W x D x H)	30 x 90 x 130mm (1.18in x 3.54in x 5.12in )	
Weight	0.7Kg	
<b>Environment</b>		
Environment specification	Operating temperature: -40℃~85℃ , operating humidity: 5%~95%	
	Storage temperature: -40℃~85℃ , storage humidity: 5%~95%	
Warranty	5 Years	

### Installation Models

#### Power Terminal

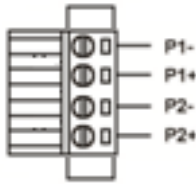

- ◆ 4-pin 3.81mm-spacing plug-in terminal
- ◆ 12V-54VDC wide voltage input
- ◆ P1&P2 dual power input
- ◆ Reverse protection

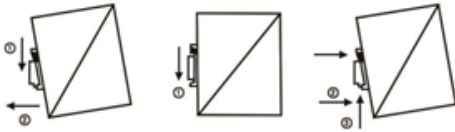

#### Din-Rail

#### Earth Protection

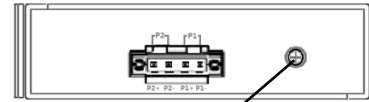

Ground screw

### Mechanical Drawing

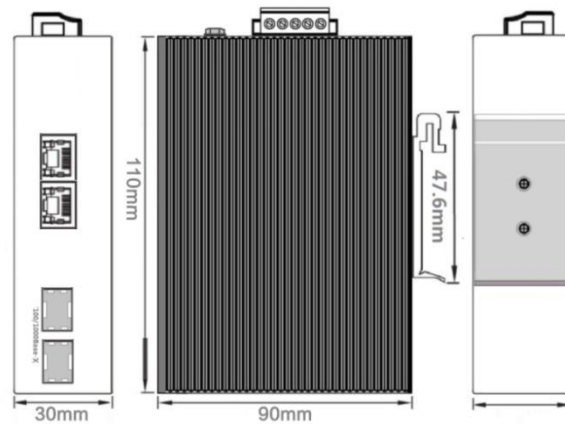

### Applications

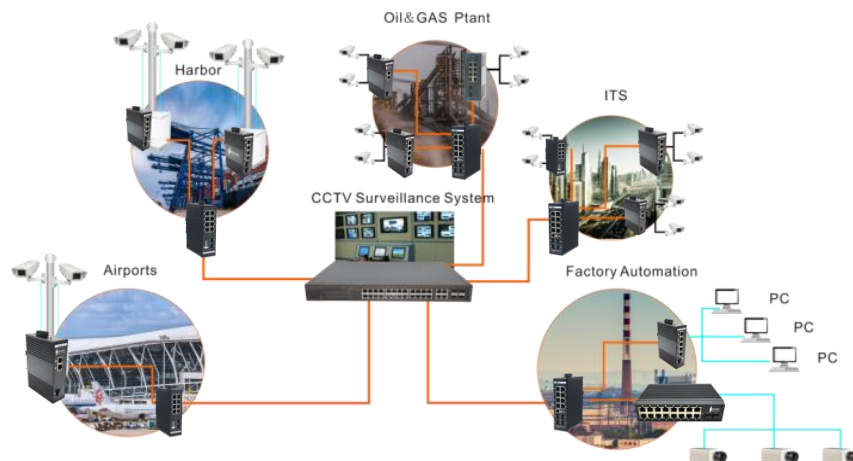

#### Ordering Information

BI6202G2F

2 Ports 10/100/1000Mbps Industrial Unmanaged Switch With 2Gigabit SFP,Din Rail



# 337 Forest Road  
London, United Kingdom



+44 7859 571344



Info@bornelectronics.com



https://bornelectronics.com